

Materials, Tools & Accessories

Disks

Part No.	Description	Diameter	Box Qty.	Approx. Box Wt. (lbs.)
DISK15/65	Used in molds using 15 thru 65 weld metal	3/4"	20	1/8
DISK90/115	Used in molds using 90 thru 115 weld metal	1"	10	1/8
DISK150/500	Used in molds using 150 thru 250 weld metal	1-1/2"	10	1/4

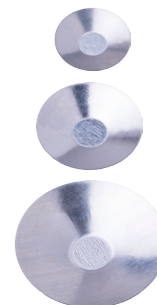

- The disk rests on the bottom of the crucible and holds the weld metal powder in place until the reaction occurs.
- A new disk is required each time a weld is made.
- Disks are included with the NUWTUBE Weld Metal.

Disk Kit

Part No.	Qty.	Approx. Each Wt. (lbs.)
DISKKIT1	EA	1/4



- A Disk Kit contains three sizes of steel disks; 60 small, 30 medium and 30 large.

Mold Fastening & Mounting

Mold Handle Clamps

Part No.	Application	Qty.	Approx. Each Wt. (lbs.)
MH1	For All molds with B, E, K, P & Q mold price key (3" wide)	EA	2-3/4
MH2	For All molds with C, D, F, Y & Z mold price key	EA	3-1/2
MH3	For Combo molds with L & M mold price key	EA	1/4
MH4	For Combo molds with R mold price key	EA	1-1/2
MH6	For 3 Piece I mold price key	EA	4-3/4
MH7	For 3 Piece J mold price key	EA	5

- Mold Handle Clamps are required for all molds.
- Some molds are used with specialized frames.
- Handle clamps have a Zinc plated finish.

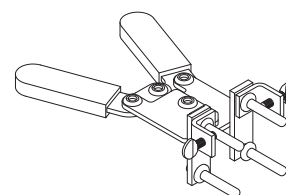

MH3

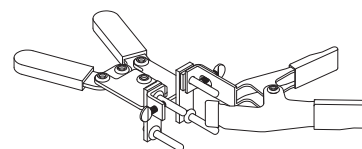

MH4

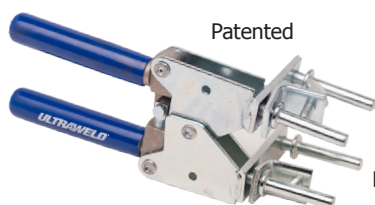

MH1, MH2

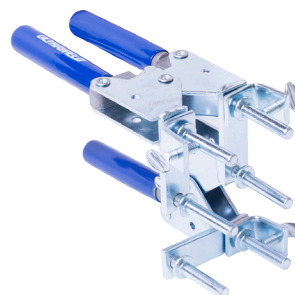

MH6, MH7

Materials, Tools & Accessories

Mold Fastening & Mounting continued

Chain Support Handle Clamps

Part No.	Fits Mold Price Key	For Following Connection Types	Pipe/Rebar	Qty.	Approx. Each Wt. (lbs.)
CSH1	B, E, K	RE, VA, VD, VT, VU	Vertical	EA	4
CSH2	C, D, F	VA, VD, VT, VU	Vertical	EA	4-1/2

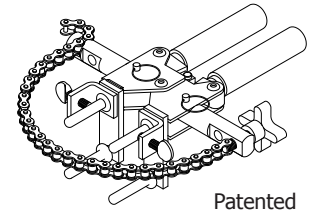

- Handle clamps CSH1 & CSH2 come with MH1 & MH2 clamps respectively as well as a CSKIT and flint igniter (FLTIG).
- Chain Support Handle Clamps are used to securely hold the mold to either a vertical or horizontal pipe.
- A 20" length of chain, which fits up to 4" pipes, comes with the chain support handle clamps.
- Extra chain length is available. Please contact factory for details.

Chain Support Kits

Part No.	Fits Mold Price Key	For Following Connection Types	Pipe/Rebar	Qty.	Approx. Each Wt. (lbs.)
CSKIT	B, C, D, E, F, K	RE, VA, VD, VT, VU	Vertical	EA	2
CSKITHSVM	B, C	VH, RS	Vertical	EA	3
CSKITHP	B, C	HB, HD, HT, HU	Horizontal	EA	3-1/4
CSKITHPVS	B	HTCP, RO	Horizontal	EA	4

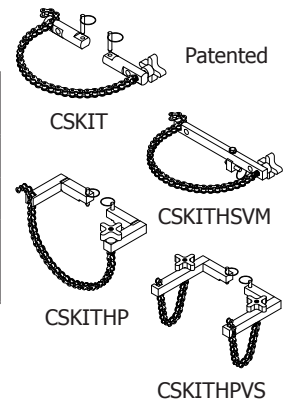

- These kits convert standard mold handle clamps into chain support clamps.

Magnetic Support Handle Clamps

Part No.	Fits Mold Price Key	Minimum Width Requirements	Qty.	Approx. Each Wt. (lbs.)
MSHC1	B, E, K	8"	EA	6
MSHC2	C, D, F	8"	EA	6-1/2

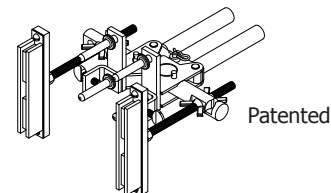

- Handle clamps MSHC1 & MSHC2 come with MH1 & MH2 clamps respectively as well as a MSKIT and a flint igniter (FLTIG).
- Magnetic Support Handle Clamp allows mold to be securely held in place to steel surfaces.
- MSKIT converts the standard mold handle clamp into a magnetic support handle clamp.

Magnetic Support Kits

Part No.	Fits Mold Price Key	Minimum Width Requirements	Qty.	Approx. Each Wt. (lbs.)
MSKIT	B, C, D, E, F, K	8"	EA	6
MSKITHSVS	B, C, D, K	10"	EA	5

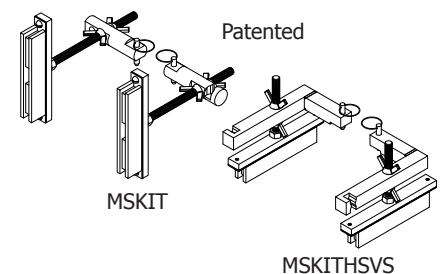

- These kits convert the standard mold handle clamp into a magnetic support handle clamp.

Materials, Tools & Accessories

Mold Fastening & Mounting continued

Hold Down Kit

Part No.	Qty.	Approx. Each Wt. (lbs.)
UMHDKIT	EA	1-1/2
UMMHDA	EA	1/2

- UMHDKIT: Attaches easily to MH1 & MH2 handle clamps for holding mold in place.
- UMMHDA: Used for horizontal "A" molds.



UMHDKIT



UMMHDA

Mold Handle Clamp Kits

Part No.	Fits Mold Price Key	Kit Includes	Qty.	Approx. Each Wt. (lbs.)
ULTRAMH1KIT	B, E, K	MH1, CSKIT, MSKIT	EA	7
ULTRAMH2KIT	C, D, F	MH2, CSKIT, MSKIT	EA	7-1/2

- Handle clamps MH1 & MH2 come with a flint igniter (FLTIG).
- Chain Support Handle Clamp securely holds mold to a vertical pipe.
- Magnetic Support Handle Clamp holds mold securely in place when welding to steel surfaces.

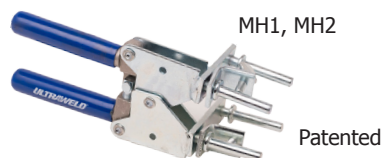

MH1, MH2

Patented



CSKIT



MSKIT

Mold Stabilization Spike Kit

Part No.	Qty.	Approx. Each Wt. (lbs.)
MLDSTBLZR	EA	2

- Help stabilize the mold when making cable to cable connections in the trench.
- Fits both the MH1 and MH2 mold handle.
- Kit Includes:
 - (2) 6" spike
 - (2) 12" spike
 - (1 set) Mold handle adapter
 - (1 set) Quick release pin



Mold Blanket

Part No.	Qty.	Approx. Each Wt. (lbs.)
ULTRAWRAP	EA	2

- Contains an inner and outer E-glass yarn with a padded non-crystalline silicate filling, finished with Kevlar®.
- Extends mold life by protecting against shock impact caused by rough handling.
- Protects exothermic welders from coming into contact with hot molds.
- Used as a protection blanket against weld splatter.

