

Equipment Ground Plates

APPLICATION NOTE:

Equipment ground plates are cast into concrete structures to offer convenient connection points to the ground system. The cast ground plates are made from high quality copper alloy and are easily exothermically welded to copper conductors. The resulting connection has an ampacity that surpasses that of the conductor or the stud.

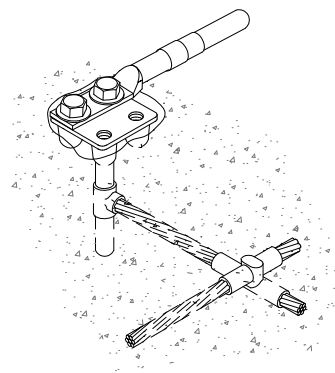

Part No.	Stud Size	Qty.	Approx. Each Wt. (lbs.)
XGP2.5/2.54/0	4/0 AWG Conc	EA	2
XGP2.5/2.55CM	500 MCM Conc	EA	2

- Stud fits mold openings for concentric strand conductor of stud size listed.

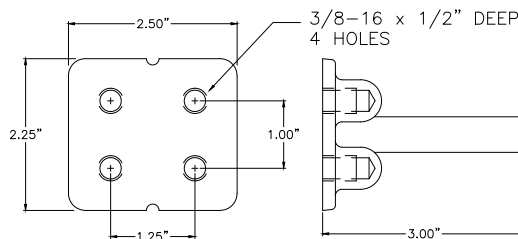

Part No.	Stud Size	Qty.	Approx. Each Wt. (lbs.)
XGP1.75/3.254/0	4/0 AWG Conc	EA	1-1/2

- NEMA hole spacing.
- Stud fits mold opening for concentric strand conductor of stud size listed.

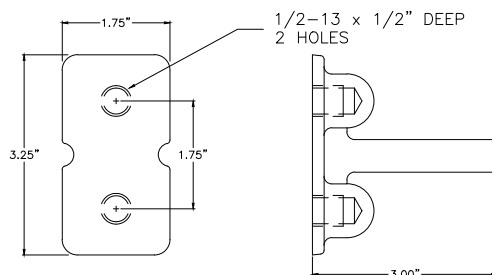

Part No.	Stud Size	Qty.	Approx. Each Wt. (lbs.)
XGP3.25/3.254/0	4/0 AWG Conc	EA	2-1/2
XGP3.25/3.255CM	500 MCM Conc	EA	2-1/2

- NEMA hole spacing.
- Stud fits mold openings for concentric strand conductor of stud size listed.

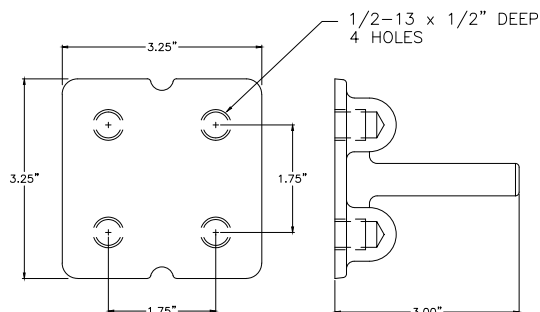

NOTES:

- Use Ultraweld Type EGPCB or EGPCT molds to make straight splices or tee connections with ground conductors to equipment ground plates.
- Custom assemblies available. Please contact factory for more information.

Equipment Ground Plate Molds

Mold Information:

- Molds listed are for stranded cable. For solid conductor, add suffix "S" after conductor number. i.e. 4S = 4 AWG solid conductor.
- Price Key is the **Bold Letter** in the Mold Part No.
- For mold Wear Plates, add suffix "WP" to the end of the Mold Part No. See page 315 for details.

Required Tools & Accessories:

MH1 - Handle for "B" Price Key Molds

Recommended Tools & Accessories:

CCBRSH1 - Cable Cleaning Brush

MCBRSH1 - Mold Cleaning Brush

Plate Stud Size	Cable	Mold Part No.	Weld Metal	
			UltraShot	NUWTUBE
4/0	1/0	EGPCB4/01/0B	US90	NUWTUBE90
4/0	2/0	EGPCB4/02/0B	US90	NUWTUBE90
4/0	4/0	EGPCB4/04/0B	US90	NUWTUBE90
4/0	1/0	EGPCT4/01/0B	US115	NUWTUBE115
4/0	2/0	EGPCT4/02/0B	US115	NUWTUBE115
4/0	4/0	EGPCT4/04/0B	US150	NUWTUBE150
4/0	1/0	EGPID4/01/0B	US150	NUWTUBE150
4/0	2/0	EGPID4/02/0B	US150	NUWTUBE150
4/0	4/0	EGPID4/04/0B	US150	NUWTUBE150
4/0	1/0	EGPIO4/01/0B	US150	NUWTUBE150
4/0	2/0	EGPIO4/02/0B	US150	NUWTUBE150
4/0	4/0	EGPIO4/04/0B	US200	NUWTUBE200

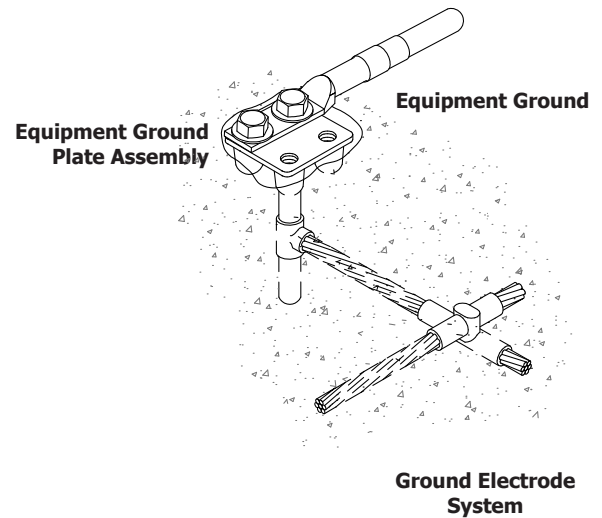

Mold Type	EGPCB	EGPCT	EGPID	EGPIO
Connection	BS	RT	GD	GO
Ground Plate Assemblies				

NOTE:

- Style EGPID and EGPIO assemblies have posts formed from the Ultraweld connection that fit into 1/2" pipe that is used for support and positioning the ground plate.

Prefabricated Equipment Ground Plate Assemblies

APPLICATION NOTE:

Equipment ground plates are cast into concrete structures to offer convenient high quality connection points to the ground system. The equipment ground plate assemblies provide ease of installation and reduce labor.

- The assembly is made to customer specifications per the part numbering system shown below.
- Equipment ground plates are manufactured from high quality cast copper alloy.
- Meets requirements of Federal Specification QQ-B-691B.2 and ASTM B584.
- The copper conductor is factory welded using the Ultraweld process.

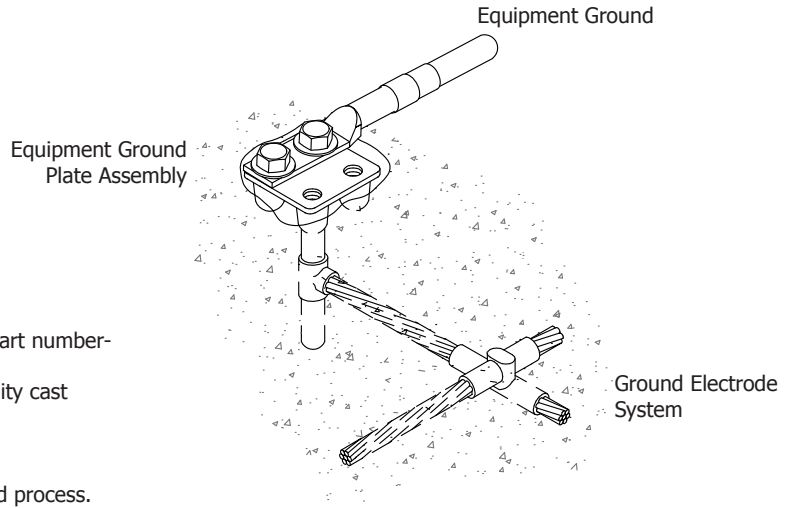

Part Numbering System:

"XGP" + "Style" + "Ground Plate Designation Code" + "Conductor" + "X" + "Conductor Length (in.)"

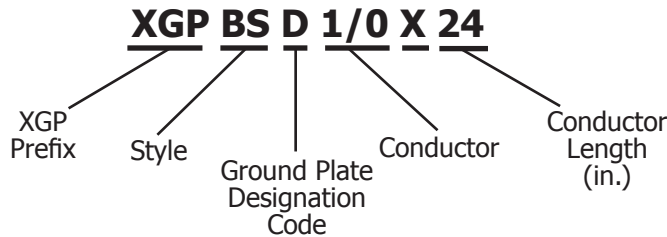

BS Style	RT Style	GD Style	GO Style

NOTE:

- Style GD and GO assemblies have posts formed from the Ultraweld connection that fit into 1/2" pipe that is used for support and positioning the ground plate.

Equipment Ground Plate Assemblies

Ground Plate Designation Code:

Ground Plate Code	Ground Plate Part Number	Stud Size	Ground Plate Figure
A	XGP1.75/3.254/0	4/0 AWG Conc	
B	XGP2.5/2.54/0	4/0 AWG Conc	
C	XGP2.5/2.55CM	500 MCM Conc	
D	XGP3.25/3.254/0	4/0 AWG Conc	
E	XGP3.25/3.255CM	500 MCM Conc	

Part Numbering Example:

Part Number: **XGP BS D 1/0 X 24** is a XGP3.25/3.254/0 Equipment Ground Plate with 1/0 conductor 24" long welded with Ultraweld BS connection.

Most Common Assemblies:

Part No.	Stud Size	Qty.	Approx. Each Wt. (lbs.)
XGPBSD2/0X12	2/0-19 AWG Conc	EA	2
XGPBSD1/0X24	1/0-19 AWG Conc	EA	2

- NEMA hole spacing.
- Stud fits mold openings for concentric strand conductor of stud size listed.

